



夕やけホール



YUYAKE HALL



施設説明 DESCRIPTION OF THE BUILDING

大自然の中でのセミナーやイベントで、一味違うビジネス体験を。童謡「夕焼け小焼け」のモデルとして知られる上恩方町「夕やけ小やけふれあいの里」の施設内にあり、さまざまな体験講座も楽しめます。「夕焼け小焼け」の作詞家・中村雨紅の資料や地元出身の写真家・前田真三の作品の展示、レストラン、宿泊施設（日帰り入浴可）やキャンプ場も併設しています。

Enjoy a different kind of business experience through seminars and events in the midst of nature. Located in Kamiongatamachi—known as the town the nursery rhyme "Yuyake Koyake" was based on—Yuyake Koyake Fureai no Sato is the venue for a wide variety of hands-on classes. There are materials to do with Yuyake Koyake composer Uko Nakamura, an exhibition of works by photographer Shinzo Maeda (who was born in the area), a restaurant, accommodation facilities (with baths that are also available to day-trip visitors), and a camping area.

アクセス ACCESS



電車 By Train JR・京王高尾線「高尾駅」北口より西東京バス「陣馬高原下」行きで約30分「宮の下」下車すぐ

From the North Exit of Takao Station on the JR Line and Keio Takao Line, take the Nishi Tokyo Bus bound for Jinbakokenshita for approximately 30 minutes, and get off at Miyanoshita

車 By Car 圏央道「八王子西インター」より川原宿交差点を経て陣馬街道約10分

From the Hachioji-nishi IC on the Ken-O Expressway, go through Kawaranoshuku intersection, then along the Jinbakaido road for approximately 10 minutes

駐車場 Parking 11台（他に夕やけ小やけふれあいの里の駐車場200台）無料
11 spaces (with a further 200 spaces at Yuyake Koyake Fureai no Sato), free of charge

住所 Address 〒192-0156 八王子市上恩方町2030
2030 Kamiongatamachi, Hachioji City, 192-0156

電話 Tel. 042-652-4126 **利用時間** Opening Hours 9:00～22:00

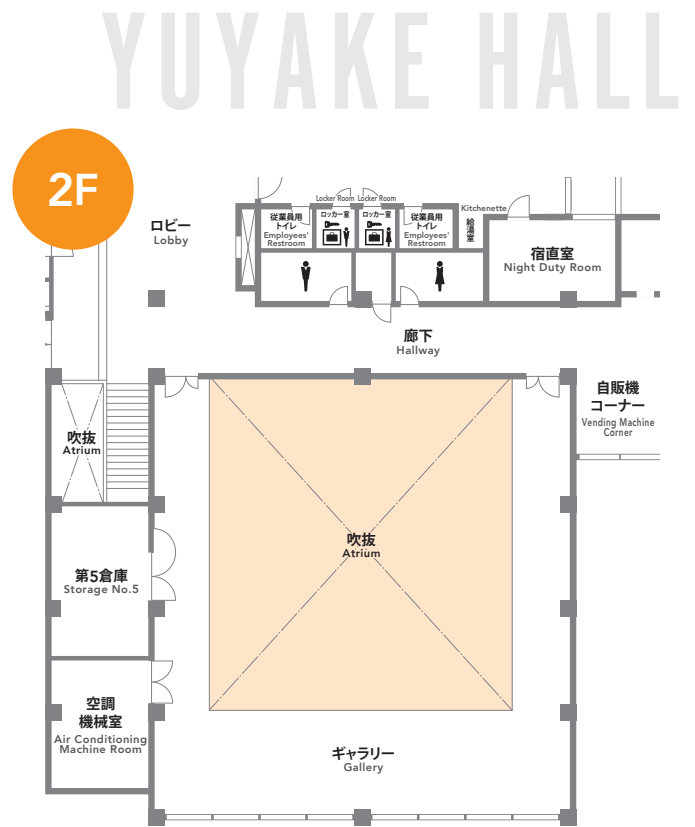

施設概要

BUILDING OVERVIEW

広さ Size	192㎡
天高 Ceiling Height	6.7m
収容人数 Capacity	スクール 200名 シアター 137名 School 200 people Theater 137 people

設備

FACILITIES

舞台 Stage	(幅)12,000mm×(奥行)5,000mm (Width) 12,000 mm x (Depth) 5,000 mm
スクリーン Screens	1基 1
机 Desks	(幅)1,800mm×(奥行)600mm 18台 18 (Width) 1,800 mm x (Depth) 600 mm
いす Chairs	(幅)440mm×(奥行)440mm 129脚 129 (Width) 440 mm x (Depth) 440 mm

フロア案内

FLOOR GUIDE



1F

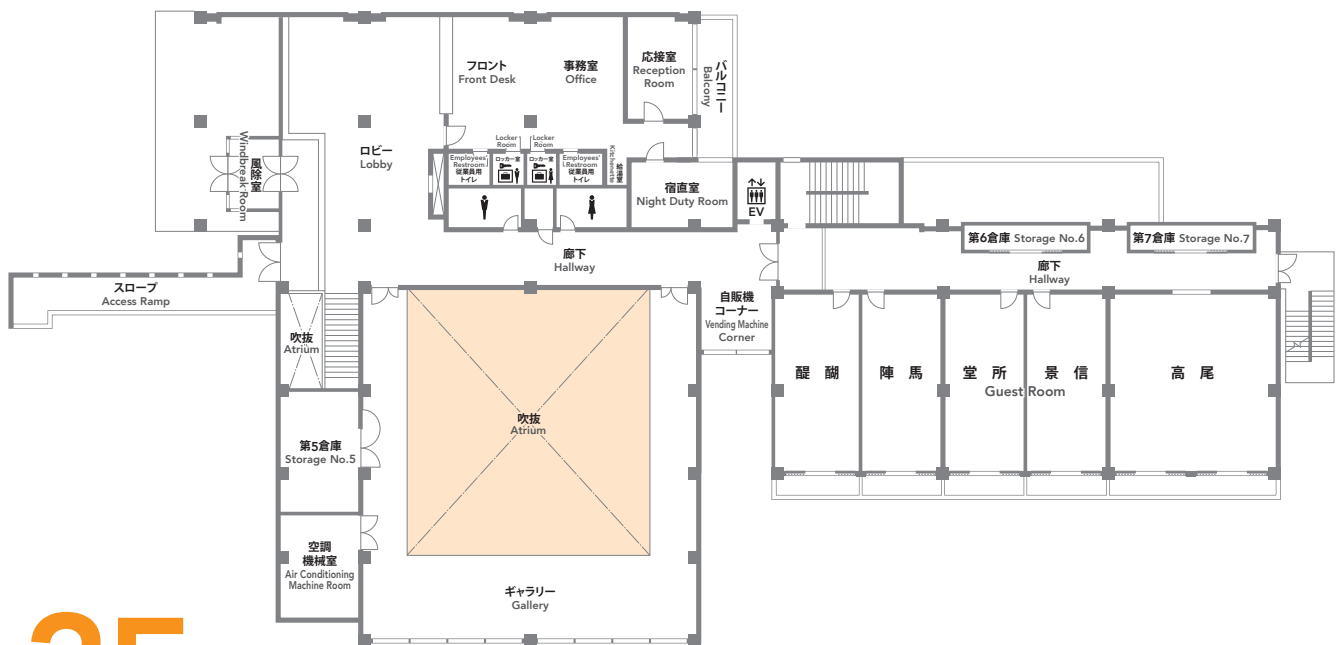

2F